

Aerator Jet



Description - Produces a single stream of foaming water suitable for use in groups. Foam effect can be adjusted by moving the upper portion of the nozzle up or down.

Sizes - Available from 19mm to 50mm inlet sizes

MOC - Cast Bronze / Brass with SS fasteners.

Custom - Custom bore sizes and inlets are possible.

Type - Direction adjustable and Water level dependent nozzle.

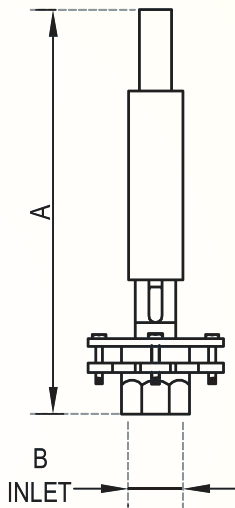

Dimensions

| SAP Code | MODEL | A | Inlet (B) |
|----------|----------------|-------|-----------|
| NOZ1.01 | Aerator 19/200 | 200mm | 19mm |
| NOZ1.02 | Aerator 25/200 | 200mm | 25mm |
| NOZ1.03 | Aerator 40/250 | 250mm | 40mm |
| NOZ1.04 | Aerator 50/400 | 400mm | 50mm |

Flow Rate for Aerator Nozzle

| MODEL | Aerator 19/200 | Aerator 25/200 | Aerator 40/250 | Aerator 50/400 |
|------------------|----------------|----------------|----------------|----------------|
| Spray Ht. (in m) | LPM | LPM | LPM | LPM |
| 1.00 | 14 | 24 | | |
| 1.50 | 17 | 29 | 54 | 104 |
| 2.00 | 20 | 33 | 58 | 121 |
| 3.00 | 24 | 41 | 72 | 147 |
| 4.00 | 28 | 47 | 83 | 170 |
| 6.00 | | 57 | 102 | 208 |
| 8.00 | | | 117 | 240 |
| 10.00 | | | 131 | 268 |
| 12.00 | | | 160 | 294 |
| 15.00 | | | | 329 |